

SPR300 PRO

OPERATOR MANUAL



B&T AG
3608 Thun • Switzerland
Tel +41 33 334 67 00
info@bt-ag.ch
www.bt-ag.ch

Table of content

1. General rules	5
1.1 Safety rules	5
1.2 Maintenance rules	5
2. Technical specifications.....	6
2.1 Overview - SPR300 PRO.....	6
2.2 General description	6
2.3 Technical data	7
3. Nomenclature.....	8
3.1 Weapon complete.....	8
3.2 Weapon disassembled.....	8
4. Handling and operating procedures	9
4.1 Clearing the weapon.....	9
4.2 Safety lever	10
4.3 Magazine catch	10
4.3.1 Position the magazine catch.....	10
4.3.2 Operating magazine catch.....	10
4.4 Bipod	11
4.4.1 Engaging bipod	11
4.4.2 Height adjustment bipod	11
4.4.3 Folding bipod.....	11
4.5 Operating the stock	12
4.5.1 Folding the stock.....	12
4.5.2 Unfolding the stock	12
4.6 Pistol grip cover.....	13
4.6.1 Open the pistol grip cover.....	13
4.6.2 Close the pistol grip cover	13
4.7 Bolt	13
4.7.1 Opening the bolt.....	13
4.7.2 Closing the bolt	13
4.8 Loading and unloading the weapon	14
4.8.1 Loading the weapon.....	14
4.8.2 Unloading the weapon during firing sessions	14
4.8.3 Unloading the weapon for storage	15
4.8.4 Preparing the weapon after storage	15
4.9 Firing the SPR300 PRO.....	16
5. Maintenance procedures	17
5.1 Disassembly of the weapon	17
5.2 Cocking and decocking the bolt.....	18
5.2.1 Decocking the bolt	18
5.2.2 Cocking the bolt	18
5.3 Cleaning and inspections.....	19

5.4	Reassembly.....	19
5.4.1	Reassembly of the weapon.....	19
5.5	Functional check	20
5.6	Troubleshooting table	21
6.	Accessories.....	22
6.1	Stocks.....	22
6.2	Magazines.....	22
6.3	Silencer	23
6.4	Brass catcher	23
6.5	Lamps	23
6.6	Montagen.....	24
6.7	Sights	24
6.8	Grips	25
6.9	Bipod	25
6.10	Maintenance	26
7.	Warranty statement	27

Related documents

Parts cataloguePC-SPR300 PRO-00-EN
Service Manual..... -

NOTE!



This operator manual covers the entire SPR300 PRO weapon family.
On the pictures show normally the standard version.
Where necessary the operating steps are shown separately for the different variants
Due to continuous efforts to improve the weapon, it is possible that certain descriptions
in this manual may differ from the actual weapon.

Abbreviations

POA: Point of Aim
POI: Point of Impact
MPI: Mean Point of Impact
Linke / rechte Seite: Defined looking in firing direction

EYE PROTECTION MUST BE WORN!



SAFETY GOGGLES MUST BE WORN WHEN DISASSEMBLING AND REASSEMBLING THE GUN. PARTS CAN GET INTO THE EYES IF HANDLED INCORRECTLY.

EAR PROTECTION MUST BE WORN!



SUITABLE HEARING PROTECTION MUST ALWAYS BE WORN WHEN SHOOTING WITH A FIREARM.

1. General rules

READ MANUAL BEFORE USE.

1.1 Safety rules

1. Consider every weapon loaded until checked personally by the individual operator.
2. Always keep fingers off the trigger and outside the trigger guard until the sights are on target.
3. Always point the weapon in a safe direction.
4. Verify your target and the backstop.
5. Before firing always verify the serviceability and condition of both the weapon and ammunition.
6. Hearing and eye protection are mandatory.
7. Be sure to use NATO, SAAMI or CIP certified cartridges of the correct caliber only.

SAFETY NOTE!	
	Defects that can be traced back to the use of non NATO, SAAMI or CIP ammunition (especially reloaded cartridges) are not covered by the guarantee!

8. If a cartridge fails to ignite, keep the muzzle pointed in a safe direction and open the chamber only after a minimum of 30 seconds.
9. Live fire training should be carried out in open or well-ventilated areas to prevent excessive exposure to toxic gases.
10. Operate your weapon consciously and do not use excessive force.

1.2 Maintenance rules

1. The weapon is to be cleaned after each deployment or firing.
2. Any malfunctions are to be reported to the unit armorer or manufacturer.
3. The weapon is to be presented to the unit armorer for inspection after each mission or a minimum of once per year.

2. Technical specifications

2.1 Overview - SPR300 PRO



2.2 General description

The SPR300 PRO is a manually operated, integrally suppressed bolt action rifle in caliber .300 Whisper. The weapon uses a 10 round Magazine. The magazine catch is designed ambidextrous.

The bolt handle and the safety lever can be operated from the right side.

The pistol grip mounts on a M4 / AR15 compatible interface and can be interchanged with a compatible third party pistol grips.

The weapon is equipped with a folding stock, which has a height adjustable cheek piece. A bipod with length adjustable legs is also delivered with the rifle.

A scope can be attached to upper accessory rail. The scope may be included in the scope of delivery, depending on the version of the gun. The length of the upper accessory rail is designed to accept a night vision device in front of the scope.

There are additional accessory rails at the 3, 6, and 9 o'clock position which can be used for mounting, lamps and laser aiming devices.

2.3 Technical data

Designation	SPR300 PRO	
Manufacturer	B&T AG - Switzerland	
Product ID	BT-SPR300	
Caliber	.300 BLK	
Magazine capacity	10 cartridges	
Operating system	Suppressed manually operated bolt action rifle	
Rifling	4 grooves, right hand	
Rail height	29 mm / 1.14 in	
Interfaces	4 NAR accessory rails	
Scope of delivery	Weapon with magazines, bipod, cleaning kit, case	
Barrel Length	252 mm / 9.92 in	
Length- Stock folded out	1000 mm / 39.37 in	
Length - Stock folded	784 mm / 30.86 in	
Width- Stock folded out	92 mm / 3.62 in	
Width - Stock folded	120 mm / 4.72 in	
Width - Bipod	195 mm / 7.67 in	
Height	261 / 10.27 in	192 / 7.55 in
Weight	3.84 kg	

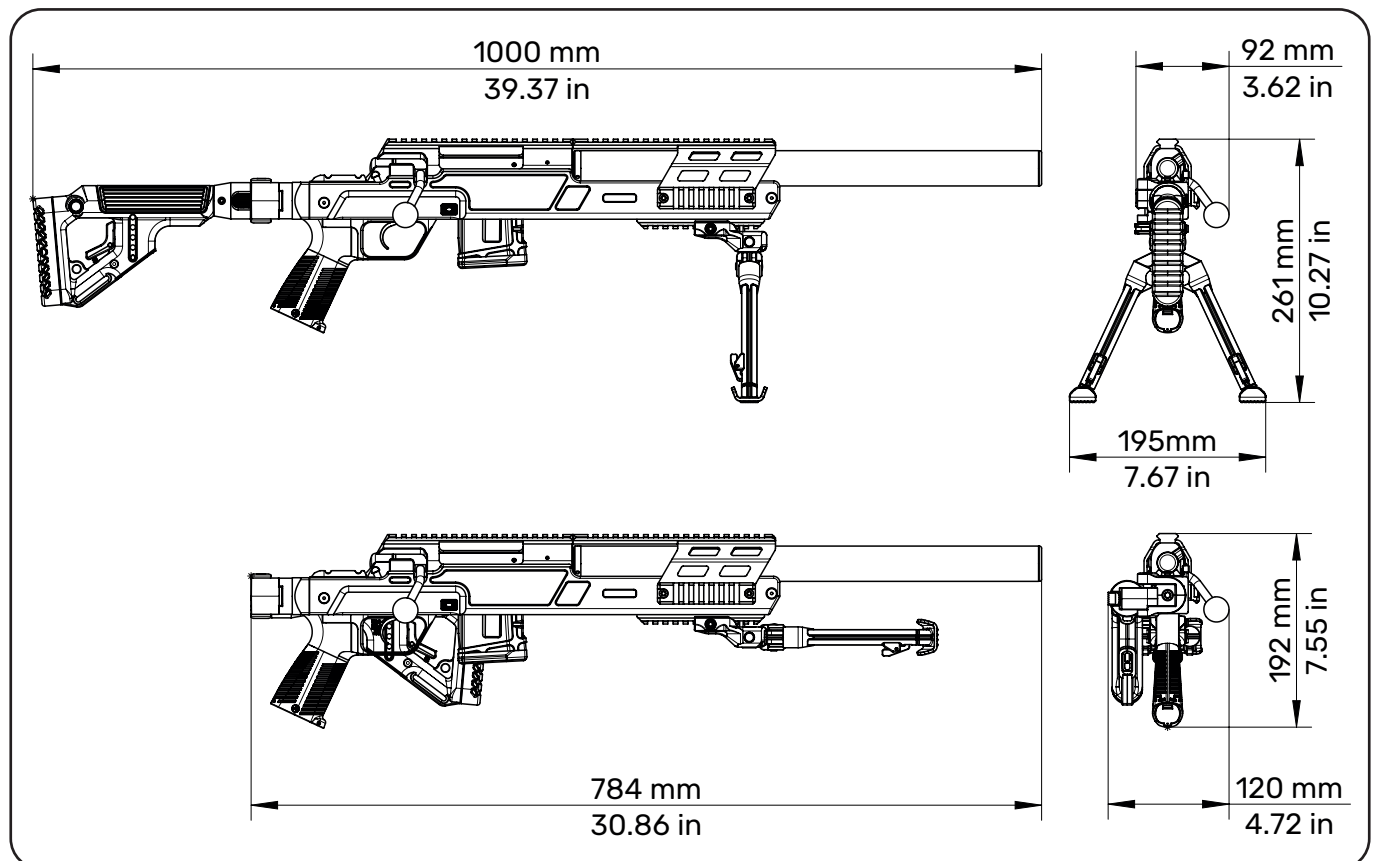

3. Nomenclature

3.1 Weapon complete

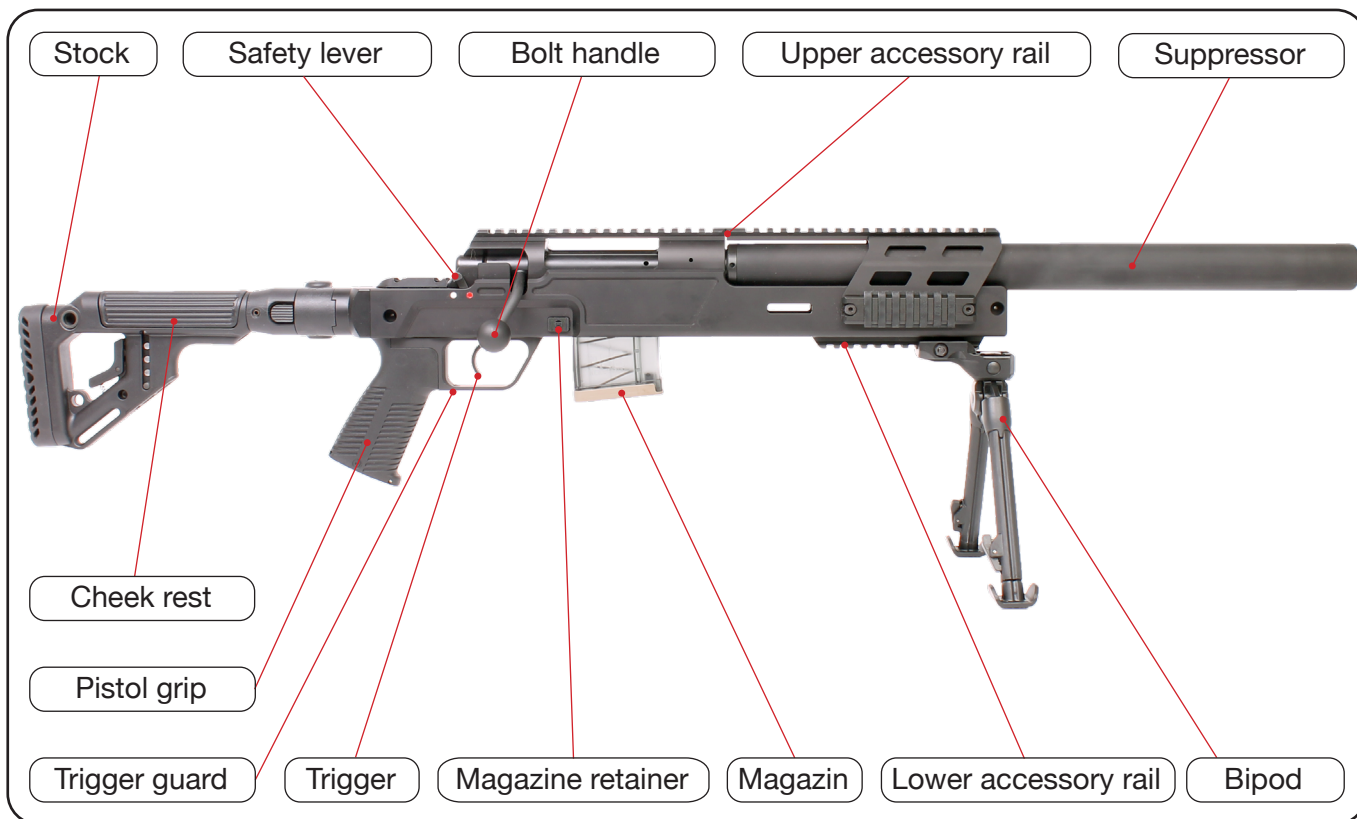

3.2 Weapon disassembled

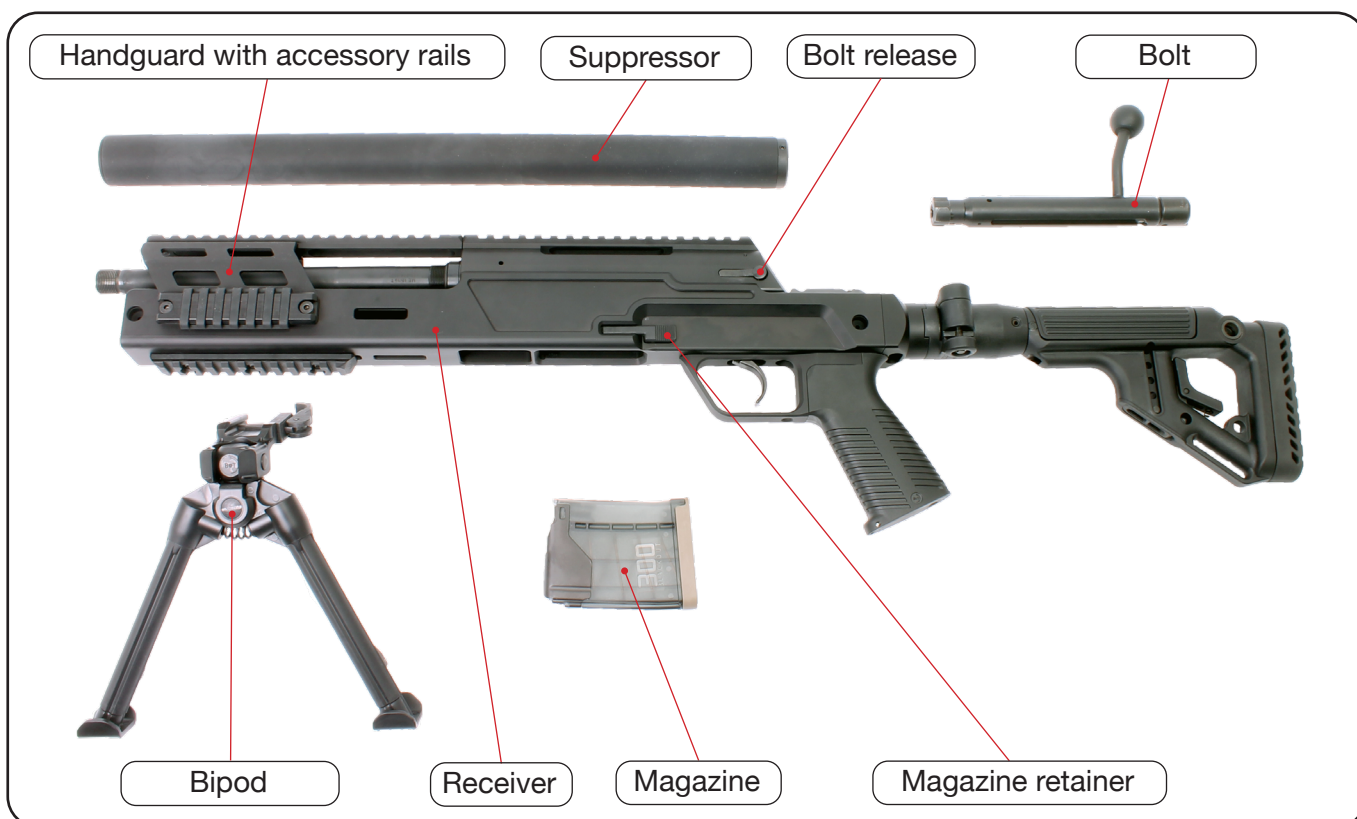

4. Handling and operating procedures

4.1 Clearing the weapon

- a. Slide the safety lever to “safe” position (see chapter „4.2 Safety lever“ on page 10).
- b. Press the magazine retainer and pull the magazine downwards out.

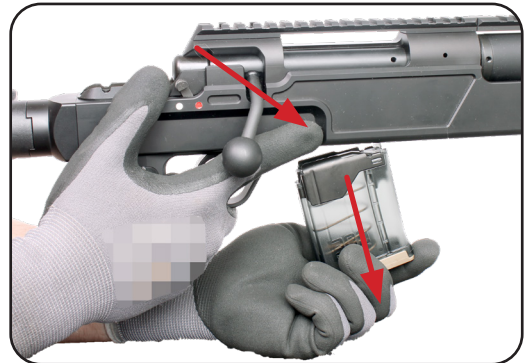

- c. Turn the bolt handle upwards and pull the bolt backwards.

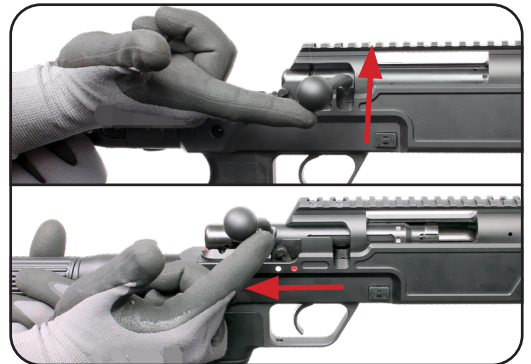

- d. Inspect the chamber visually to be clear.



4.2 Safety lever

- The positions of the safety lever are marked on the right side of the weapon.
- Slide the safety lever in order to engage the desired mode.

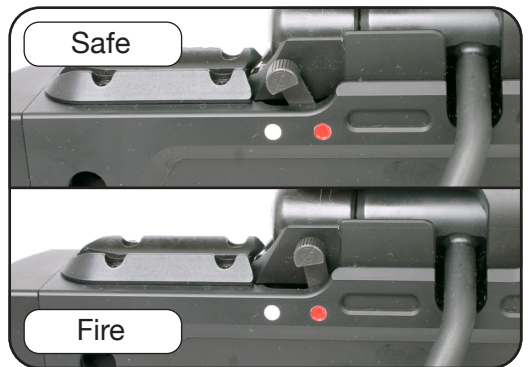
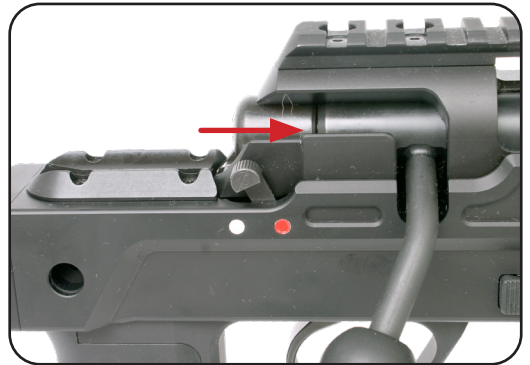

WHITE DOT = SAFE

RED DOT = FIRE

4.3 Magazine catch

4.3.1 Position the magazine catch

- The magazine catch is present on the left and right side of the receiver.

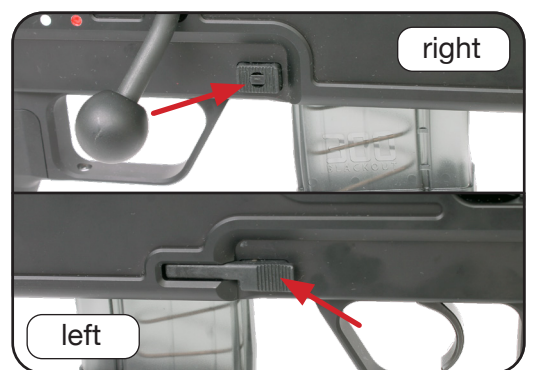

4.3.2 Operating magazine catch

- Slide the safety lever to "safe" position (see chapter „4.2 Safety lever“ on page 10).
- Press the magazine retainer and pull the magazine downwards out.

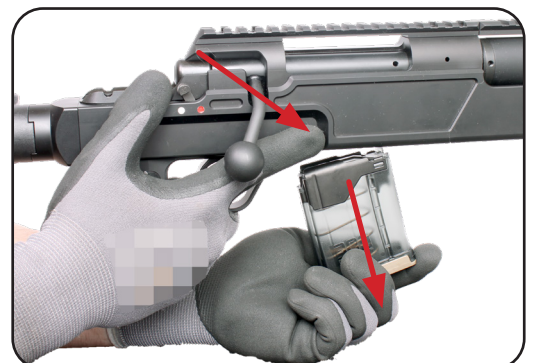

4.4 Bipod

SAFETY NOTE!



Prior to shooting, make sure that the bipod legs are locked in a correct position, corresponding to the shooting position.



4.4.1 Engaging bipod

- Grasp the legs, squeeze them together and rotate them downwards until they snap in end position.

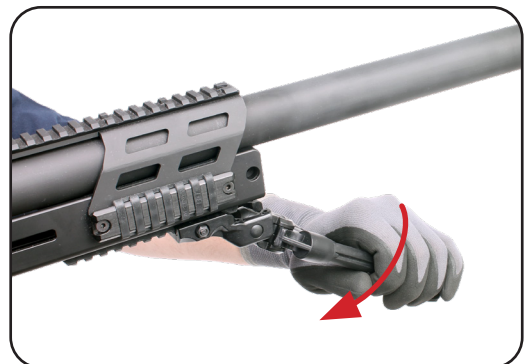

4.4.2 Height adjustment bipod

- Pull out the legs, until they audibly engage at the desired length.
- Push on the catch on the legs of the bipod to retract the legs.

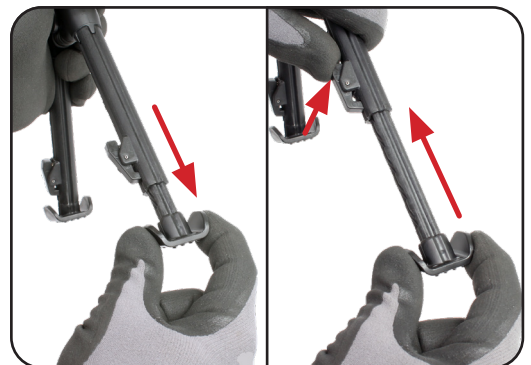

4.4.3 Folding bipod

- Squeeze the legs together and turn them forwards until they reach the horizontal position.



4.5 Operating the stock

4.5.1 Folding the stock

- a. Push on the cheek rest locking knob, and push the cheek piece all the way down.
- b. Push the folding stock locking knob and fold the stock.
- c. Fold the stock all the way until it snaps audibly in the end position.

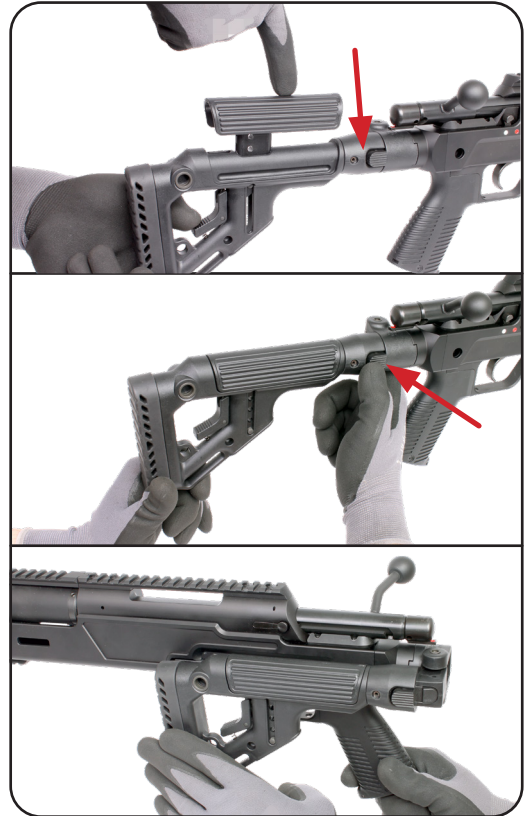

4.5.2 Unfolding the stock

- a. Grasp the weapon with the firing hand on the pistolgrip.
- b. Unfold the stock until it audibly locks audibly in the end position.
- c. Use the non-firing hand to check the correct locking of the stock.
- d. Push on the cheek rest locking knob, and pull the cheek

piece up until it has reached the desired height. Make sure it is correctly locked in one of the locking positions.

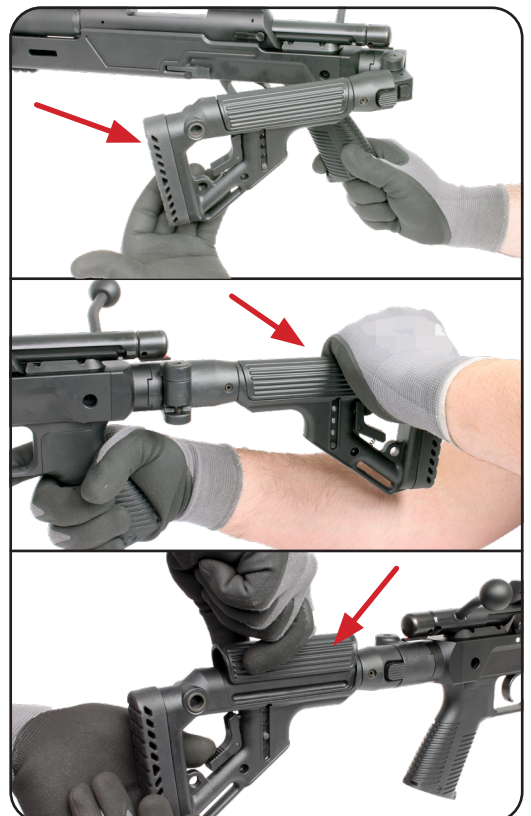

4.6 Pistol grip cover

4.6.1 Open the pistol grip cover

- Slide a screw driver in the gap at the front of the compartment cover.
- Push the cover backward and lift it up.



4.6.2 Close the pistol grip cover

- In order to close the cover, push it back until it audibly snaps into closed position.



4.7 Bolt

4.7.1 Opening the bolt

- Remove magazine (see chapter „4.3 Magazine catch“ on page 10).
- Turn the bolt handle upwards and pull the bolt backwards.

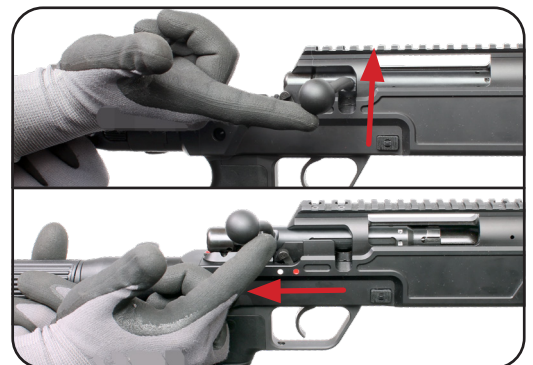

4.7.2 Closing the bolt

- Push the bolt handle to its foremost position and lock it by fold the bolt handle down.

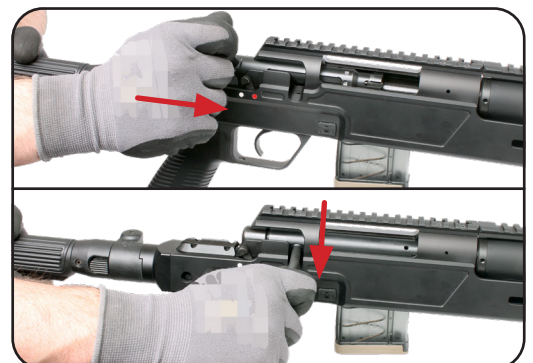

4.8 Loading and unloading the weapon

4.8.1 Loading the weapon

- Fill the cartridges one by one into the magazine.
- Grab the weapon and engage safety (see chapter „4.2 Safety lever“ on page 10).
- Insert magazine.
- Pull the magazine slightly downward to verify it is locked in place.



- If the bolt is not open, open it (see chapter „4.7.1 Opening the bolt“ on page 13).

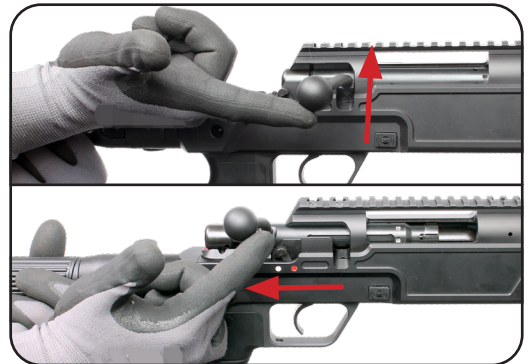

- If the bolt is open, close it vigorously (see chapter „4.7.2 Closing the bolt“ on page 13).
- The weapon is loaded.



4.8.2 Unloading the weapon during firing sessions

- Engage safety (see chapter „4.2 Safety lever“ on page 10).
- Remove the magazine (see chapter „4.3 Magazine catch“ on page 10).
- Open the bolt and observe the chambered cartridge being ejected (see chapter „4.7.1 Opening the bolt“ on page 13).
- Leave the bolt in the open position.
- Recover the loose cartridge.

4.8.3 Unloading the weapon for storage

- a. Unload the weapon (see chapter „4.8.2 Unloading the weapon during firing sessions“ on page 14).
- b. Push the bolt release at the bolt receiver and remove bolt backwards.

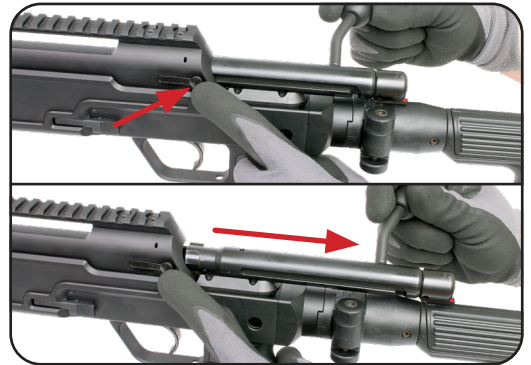

- c. Decock the bolt (see chapter „5.2.1 Decocking the bolt“ on page 18).
- d. To ensure optimum storage, apply a slight film of oil to all accessible steel.



4.8.4 Preparing the weapon after storage

- a. Apply a slight film of oil to all accessible surfaces of steel parts.
- b. Cock the bolt (see chapter „5.2.2 Cocking the bolt“ on page 18).



- c. Insert the bolt into the bolt receiver from the back end.
- d. Load the weapon (see chapter „4.8.1 Loading the weapon“ on page 14).



4.9 Firing the SPR300 PRO

SAFETY NOTE!



REFER TO SEE CHAPTER „1.1 SAFETY RULES“
ON PAGE 5

- a. Load the weapon (see chapter „4.8.1 Loading the weapon“ on page 14).
- b. Apply a proper firing position.
- c. Disengage safety (see chapter „4.2 Safety lever“ on page 10).
- d. Pull the trigger until the shot is released.



NOTE!



Refer to see chapter „5.5 Functional check“ on
page 20

5. Maintenance procedures

5.1 Disassembly of the weapon

- a. Clear the weapon (see chapter „4.1 Clearing the weapon“ on page 9).
- b. Push the bolt release at the bolt receiver and remove bolt backwards.

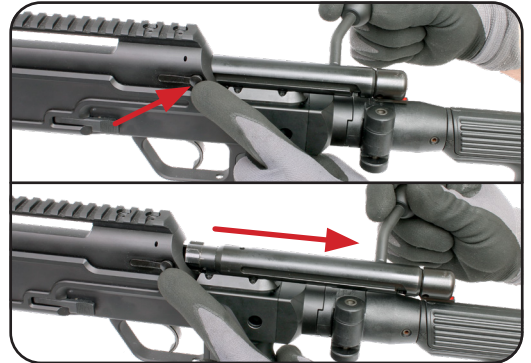

- c. Loosen the stud suppressor locking screw (do not remove).
- d. Unscrew the suppressor, counterclockwise, and remove it.

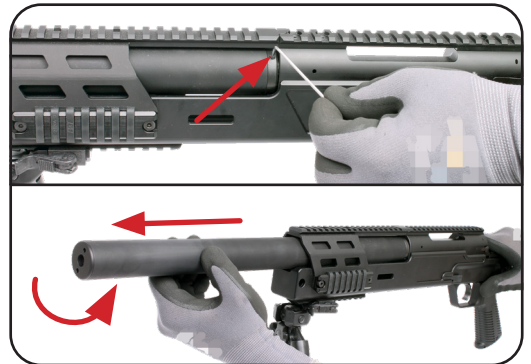

- e. Push the locking knob on the bipod attachment backwards, open the clamping system and remove the bipod.



The weapon is now disassembled and ready for cleaning and inspections.



5.2 Cocking and decocking the bolt

5.2.1 Decocking the bolt

- a. Insert a drift punch $\varnothing 4$ mm into the hole on the cocking piece.

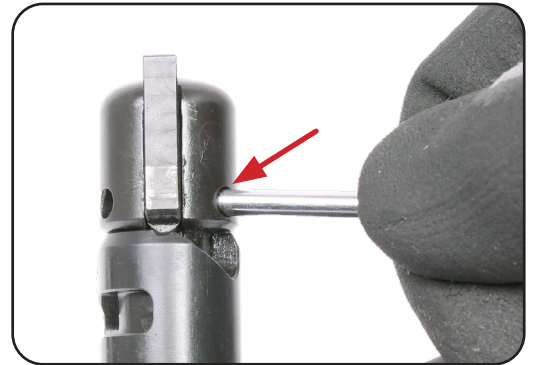

- b. To uncock the firing pin spring, turn the cocking piece with the drift punch counterclockwise until it has reached the end position on the right side.

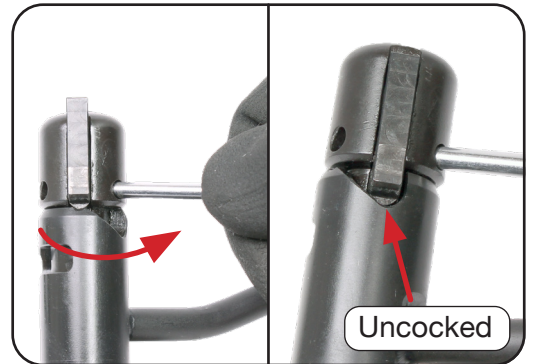

5.2.2 Cocking the bolt

- a. Insert a drift punch $\varnothing 4$ mm into the hole on the cocking piece.

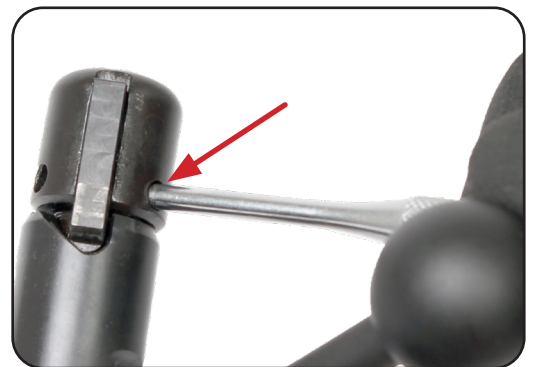

- b. To cock the firing pin spring, turn the cocking piece with the drift punch clockwise until it has reached the end position on the left side.

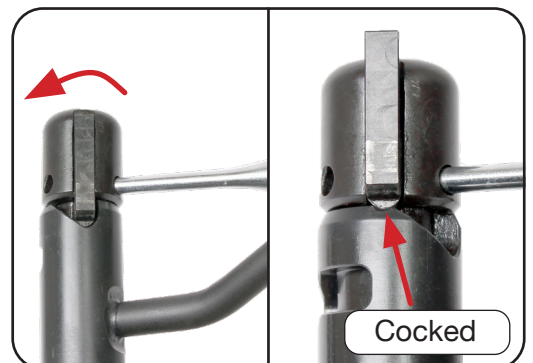

5.3 Cleaning and inspections

- Use a cleaning rod of suitable length with a copper brush to clean the barrel from the rear side.
- Use a small brush to remove particles captured in the cavities of lower and upper receiver.
- Use an oiled rag to wipe clean all accessible surfaces.
- Inspect all components and accessible parts for cracks, deformations or other signs of deterioration.
- Apply a slight film of oil to all accessible surfaces of steel parts.

SAFETYNOTE!



ADDRESS TO AN ARMORER IF THE SERVICE-ABILITY OF THE WEAPON SEEMS DOUBTFUL

5.4 Reassembly

5.4.1 Reassembly of the weapon

- Mount the bipod on the lower accessory rail and secure it with the clamping system.
- Screw the suppressor onto the barrel clockwise and secure it with the stud screw.
- Insert the bolt into the bolt receiver from the back end.
- Execute a functional check (see chapter „5.5 Functional check“ on page 20).



5.5 Functional check

- a. Clear weapon (see chapter „4.1 Clearing the weapon“ on page 9).
- b. Close the bolt (see chapter „4.7.2 Closing the bolt“ on page 13), slide the safety lever to “safe” position (see chapter „4.2 Safety lever“ on page 10) and pull the trigger. The Firing pin shall not be released.
- c. Slide the safety lever to “Fire” position (see chapter „4.2 Safety lever“ on page 10) and pull the trigger. The firing pin shall snap audibly.
- d. Fold and unfold the stock. It should engage in both positions (see chapter „4.5 Operating the stock“ on page 12).
- e. Push the magazine retainer and pull magazine downward => magazine shall come loose (see chapter „4.3 Magazine catch“ on page 10).
- f. Reinsert empty magazine. The magazine catch should audibly snap into place and hold the magazine in position (see chapter „4.3 Magazine catch“ on page 10).
- g. Grasp the suppressor and turn it counterclockwise, it should not move.
- h. Unfold the bipod, the legs should lock in the spread position (see chapter „4.4.1 Engaging bipod“ on page 11).
- i. Check the height adjustment of the bipod, it should lock in the different positions (see chapter „4.4.2 Height adjustment bipod“ on page 11).
- j. Fold in the bipod, which should engage easily in the end position (see chapter „4.4.3 Folding bipod“ on page 11).

If any function fails are discovered, disassemble the weapon, check for defective parts, reassemble the weapon and check for correct reassembly. If the failure persists, refer to armorer.

5.6 Troubleshooting table

#	Observation	Immediate action	Kap.
1	Inconsistent impacts	Control correct position and tight attachment of the Scope. Present weapon at first opportunity to armorer for inspection.	
2	Failure to feed	Open the bolt and inspect visually if a cartridge is chambered. In case of jam, remove magazine, clear and switch to other magazine.	9
3	Failure to eject	Open the bolt and observe for ejected shell or cartridge. Inspect barrel to be clear. Load a fresh cartridge. Present weapon for inspection of extractor and ejector to an armorer at the first opportunity.	14
4	Failure to strike	Open the bolt and remove possible obstructions captured in the upper receiver. Load a fresh cartridge. If failure repeats, clean weapon or present it to an armorer.	9 14
5	Failure to ignite	Wait 30 seconds with the muzzle pointing to a safe direction. Unload the weapon, observe for ejected cartridge. Collect cartridge for later analyses. Load a fresh cartridge. Present weapon and ejected cartridge to an armorer at the first opportunity.	14

NOTE!



Failure reports to the manufacturer must include the serial number of the weapon, the type of ammunitions, the history of the failure and the history of the attempted corrective actions. The report can be sent to B&T by E-Mail along with pictures.

6. Accessories

6.1 Stocks

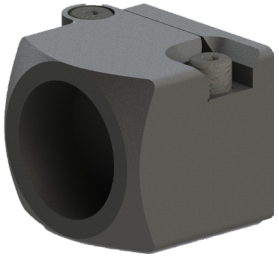
Picture	Art.-No.	Description
	BT-34058	Stock
	BT-340170	Folding adapter M4 Buffer Tube

6.2 Magazines

Picture	Art.-No.	Description
	BT-880226	Magazine 10 rounds
	BT-361173	Magazine 30 rounds

6.3 Silencer

Picture	Art.-No.	Description
	SD-988074	Suppressor



6.4 Brass catcher

Picture	Art.-No.	Description
	BT-220588	Brass catcher QD/QO SPR 300 PRO

6.5 Lamps

Picture	Art.-No.	Description
	BT-WMLX-B-W-L-GEN3	B&T Weapon Mounted Light GEN-3

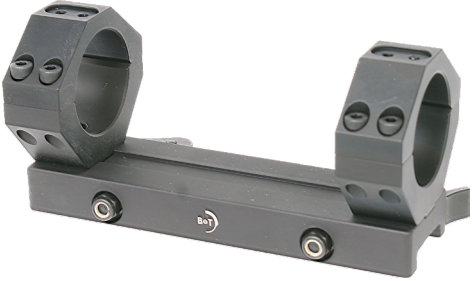
6.6 Montagen

Picture	Art.-No.	Description
	BT-34009	B&T mounting ring / Ø 30
	BT-211011	B&T base mount QD / L 128 - Ø 34
	BT-211012	B&T base mount QD / L 118 - Ø 34

6.7 Sights

Picture	Art.-No.	Description
	ME-3926514320020	Meopta Riflescope Meostar R1 1.5-6x42 RD-BT 300W

6.8 Grips

Picture	Art.-No.	Description
	BT-231227-BK	Angled fore grip 45° picatinny rail attachment
	BT-211564-BL	Unigrip QD short
	BT-21840	Unigrip QD

6.9 Bipod

Picture	Art.-No.	Description
	BT-22297	B&T Bipod

6.10 Maintenance

Picture	Art.-No.	Description
	SC-TR/M_7.62 _8-32	Stil Crin cleaning kit for rifle cal. 30/7.62 with thread 8-32 UNC
	SC-64B_7.62_8-32	Stil Crin copper brush cal. .30 thread 8-32 UNC male
	SC-64M_5.56_8-32	Stil Crin copper brush cal. .223/5.56 chamber cleaner with thread 8-32 UNC male
	SC-T-BRUSH	Stil Crin double nylon brush

7. Warranty statement

Warranty claims on behalf of the client are to be explicitly declared as such. During the legal warranty period, B&T provides warranty cover solely for defects that arise as a result of faulty materials, construction errors or poor workmanship. If a warranty claim is justified, B&T will, at its own discretion, either repair or replace the defective good. Costs incurred in transporting the defective good to B&T are borne by the Client. Spare parts fitted and replaced become the property of B&T.

Inasmuch as is legally permitted, any other liability of B&T is excluded, in particular liability for damages arising either directly or indirectly from the delivered good itself, from its use or from its defects

Merchandise is covered by the warranty provisions of the manufacturer. Parts that are naturally subject to wear and tear, damage arising from insufficient maintenance work, noncompliance with operating regulations and cases of force majeure are all excluded from warranty cover. Warranty claims lapse if the Client itself or third parties alter or repair the delivered good without the prior written consent of B&T. All product specifications are subject to change without prior notice. Published data are mean values and therefore not suitable acceptance criteria.

The manufacturer:

B&T AG - 3608 Thun - Switzerland

Phone +41 33 334 67 00

e-mail: info@bt-ag.com

Notes: